

CUNO™ ZP Model Sanitary Filter Housings



Zeta Plus Model ZP sanitary filter housings provide the ultimate standard for totally enclosed Zeta Plus cartridge filtration systems. Constructed from mirror polished 316L stainless steel, Zeta Plus ZP filter housings meet the exacting sanitary quality standards of the pharmaceutical, food and beverage, fine chemical, and micro electronics industries.

Standard Zeta Plus ZP filter housings accommodate from one to four 12" or 16" diameter standard Zeta Plus filter cartridges to offer a wide choice of filter media area and flow rates.* Multiple cartridge housings can be user fitted with shorter centre-posts to accommodate fewer cartridges.

CUNO Zeta Plus filter housings conform to AS1210 and are available in a range of customised formats including multicartridge, multihousing through to fully automated skids. Consult CUNO for assistance or specialised Zeta Plus filter housings.

Features & Benefits

Totally enclosed depth-cartridge filtration with fast and easy cartridge change-out

- Eliminates external contamination, edge leakage, loss of valuable product and long tedious change-out times associated with plate and frame filter presses

Positive spring-loaded cartridge sealing system

- Provides optimal sealing compression to prevent filter bypass even under the most arduous process conditions

Housings accommodate one to four 12" or 16" cartridges

- Suitable for small through large batch sizes and aqueous flows from 500 to 17,000 lph (2 to 75 gpm) per housing.

Internal & external mirror finish sanitary 316L stainless steel construction*

- Reduces bacterial/particle adhesion.

Optional sanitary bleed valve available

- Provides easy venting

*Model ZP housings will also accommodate Zeta Plus EXT cartridges with modification of internal parts. Consult CUNO for details. Optional Sanitary Pressure Gauge connection.

Cartridge Sealing System

A spring-loaded sealing system (sealing nut shown below) provides optimal sealing compression to help prevent filter bypass even under the most arduous process conditions.



Filter Housing Flow Rates

Filter housing flow rates are dependent on the nature of the application. Variables such as filter media formulation and grade, temperature, viscosity, and the contamination level of the fluid all will dictate the ideal flow rate. Consult with CUNO representatives for ideal system rates for your application.

Zeta Plus Depth Filters

Zeta Plus depth filters are a family of patented filtration media composed of high surface area inorganic filter aids embedded in a cellulose fiber matrix. During the manufacturing process molecules carrying a positive charge are chemically bonded to the matrix components, permanently forming an interconnected, rigid filter sheet with positively charged electrokinetic capture sites capable of retaining bacteria, endotoxins, haze components, cellular debris and submicronic contaminants to a level which mechanical screening alone can not achieve. Zeta Plus filter cartridges are available in a variety of media formulations and retention ratings designed to meet the needs of the pharmaceutical, food and beverage, fine chemicals, and micro-electronics industries. For more information about Zeta Plus media choices, please contact CUNO.

HOUSING SPECIFICATIONS

Maximum Operating Pressure & Temperature	10 bar @ 100°C (145 psig @ 212°F)
Materials of Construction:	
Base, dome, centrepost	316L stainless steel
Sealing system nut	Acetal
O-ring/gaskets*	Silicone
Inlet / Outlet Connections:	
12ZP1 & 12ZP2	1 ½" sanitary
12ZP3, 12ZP4 & 16ZP	2" sanitary
Pressure gauge connection	1 ½" sanitary
Bleed valve connection	½" sanitary
Finish:	
External finish	Mechanical polish to 0.4um
Internal finish	Mechanical polish to 0.4um

ZETA PLUS FILTER CARTRIDGE CAPACITY

Housing Model	Cartridge Dimensions Nominal (mm)		No. of cartridges	Media Area (ft ² /m ²)
	Diameter	Height		
12ZP1	305	270	1	16.4/1.5
12ZP2			2	32.8/3.0
12ZP3			3	49.2/4.5
12ZP4			4	65.6/6.0
16ZP4	410	270	4	138.8/12.8

Recommended flow rates are based on ½ GPM /ft² of media installed. Actual flow rates may vary based on many factors such as medium type, temperature, viscosity and contamination level of the fluid being filtered, and housing connections.



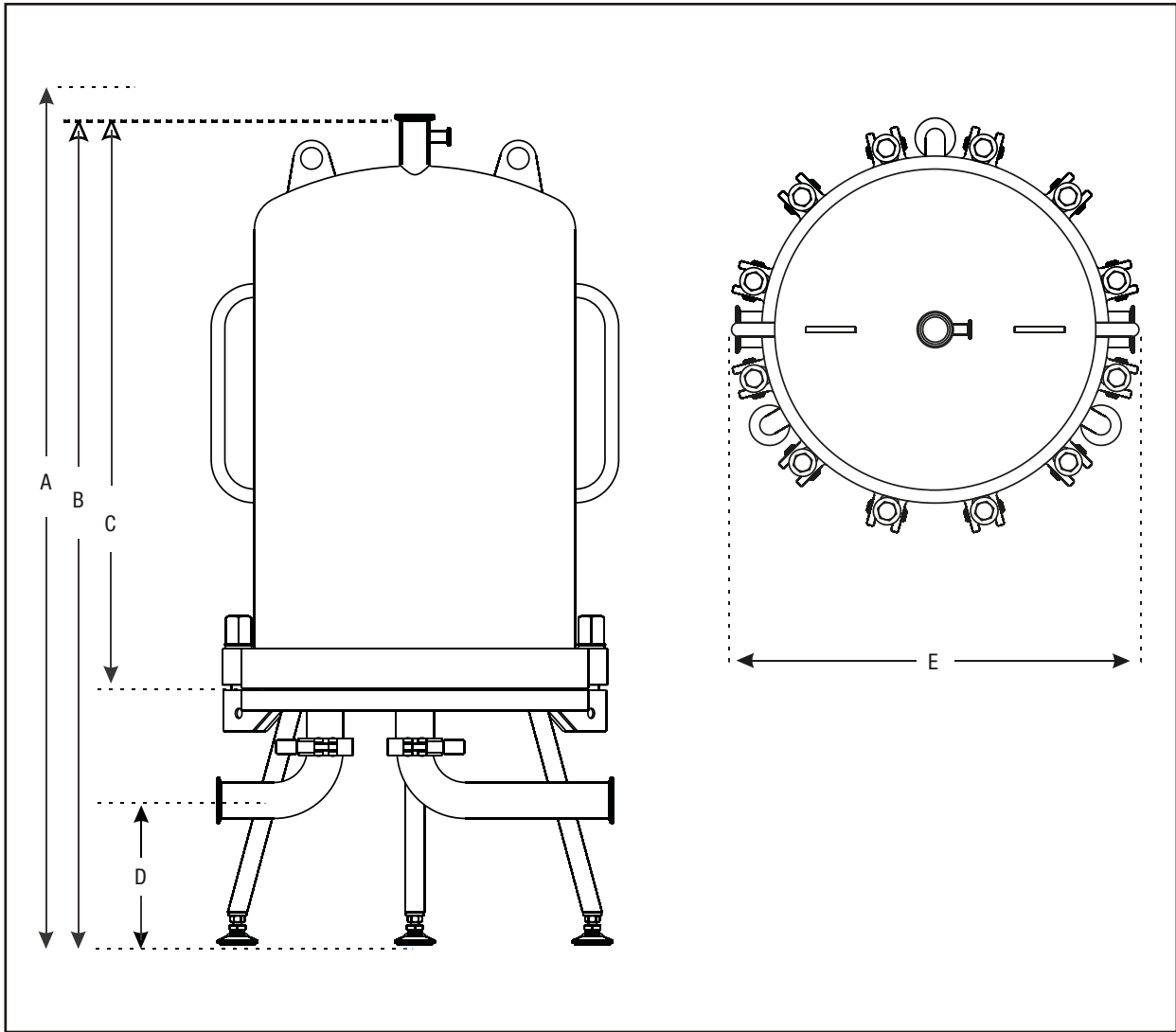

STANDARD MODEL WEIGHTS & DIMENSIONS

Housing Model	Dome Weight	Dimensions				
		A Clearance Required	B Height of Housing	C Height of Dome	D Height of Flange	E Width
12ZP1	21	1346	857	508	200	400
12ZP2	28	1930	1143	800		
*12ZP3	35	2489	1422	1080		
*12ZP4	41	2972	1665	1320	200	549
*16ZP4	67	2997	1685	1333		

Dimensions are for rough plumbing estimates only; for other details, please contact CUNO

*Models include lifting lugs on the dome.

Model ZP Housing Ordering Guide	
HOUSING MODEL	ORDER CATALOG NUMBER
12ZP1	AK200099831
12ZP2	AK200099849
12ZP3	AK200099856
12ZP4	AK200099864
16ZP4	AK200104235

Model ZP Housing Integrated Systems

ZP Model filter housings are available as complete sanitary systems including piping, valves, pressure gauges, optional feed loops, C.I.P. capabilities and skid mounted mobile systems for single source system solutions. For more information, please contact your local CUNO distributor.

Applications Support - SASS

CUNO's Scientific Applications Support Services (SASS) is staffed by scientists and engineers, with state-of-the-art laboratory facilities. SASS staff, familiar with pharmaceutical, food and beverage, fine chemicals, and micro-electronics filtration and separations, work closely with customer applications to recommend the most effective and economical CUNO filtration system.

Important Notice

CUNO MAKES NO WARRANTIES, EXPRESS OR IMPLIED, INCLUDING, BUT NOT LIMITED TO, ANY IMPLIED WARRANTY OF MERCHANTABILITY OR FITNESS FOR A PARTICULAR PURPOSE. Since a variety of factors can affect the use and performance of a CUNO product in a particular application, some of which are uniquely within the user's knowledge and control, user is responsible for determining whether or not the CUNO product is fit for a particular purpose and suitable for user's method of application.

Limitation of Remedies and Liability

If the CUNO product is proved to be defective, THE EXCLUSIVE REMEDY, AT CUNO'S OPTION, SHALL BE TO REFUND THE PURCHASE PRICE OR TO REPAIR OR REPLACE THE DEFECTIVE PRODUCT. CUNO shall not otherwise be liable for loss or damages, whether direct, indirect, special, incidental or consequential, regardless of the legal theory asserted, including, but not limited to, contract, negligence, warranty or strict liability.

Warranty

Seller warrants its equipment against defects in workmanship and material for a period of 12 months from date of shipment from the factory under normal use and service and otherwise when such equipment is used in accordance with instructions furnished by Seller and for purposes disclosed in writing at the time of purchase, if any. Any unauthorized alteration or modification of the equipment by Buyer will void this warranty. Seller's liability under this warranty shall be limited to the replacement or repair, F.O.B., point of manufacture, of any defective equipment or part which, having been returned to the factory, transportation charges prepaid, has been inspected and determined by Seller to be defective. THIS WARRANTY IS IN LIEU OF ANY OTHER WARRANTY, EITHER EXPRESSED OR IMPLIED, AS TO DESCRIPTION, QUALITY, MERCHANTABILITY, FITNESS FOR ANY PARTICULAR PURPOSE OR USE, OR ANY OTHER MATTER. Under no circumstances shall Seller be liable to Buyer or any third party for any loss of profits or other direct or indirect costs, expenses, losses or consequential damages arising out of or as a result of any defects in or failure of its products or any part or parts thereof or arising out of or as a result of parts or components incorporated in Seller's equipment but not supplied by the Seller.

For more information or technical assistance, phone

CUNOCare  **1300 367 362**



www.cuno.com.au

 **1800 671 599**

HEAD OFFICE

140 Sunnyholt Road
Blacktown NSW 2148

VICTORIA

Brandon Business Park
540 Springvale Road
Glen Waverley VIC 3150

QUEENSLAND

Unit 9
23 Breene Place
Morning Side QLD 4170

SOUTH AUSTRALIA

39-41 South Road
Thebarton SA 5031

WESTERN AUSTRALIA

4 Gould Street
Osborne Park WA 6017

NEW ZEALAND

Ph: 0800 474 787
Fax: +64 9477 4160
innovation@nz.mmm.com
www.3m.com/nz